

NOTES:

1. REMOVE WIRE AND NYLON TWINE FROM BALL AND CANOPY.
2. SOAK ROOT BALL AND PLANT PIT IMMEDIATELY AFTER INSTALLATION.
3. STAKING IS REQUIRED FOR ALL TREES IN R.O.W. OR UPON REQUEST OF PLANNING DEPARTMENT.
4. REMOVE EXCESS SOIL FROM SITE AND DISPOSE OF IN A LEGAL MANNER.
5. RESEED UNMULCHED, DISTURBED AREAS.

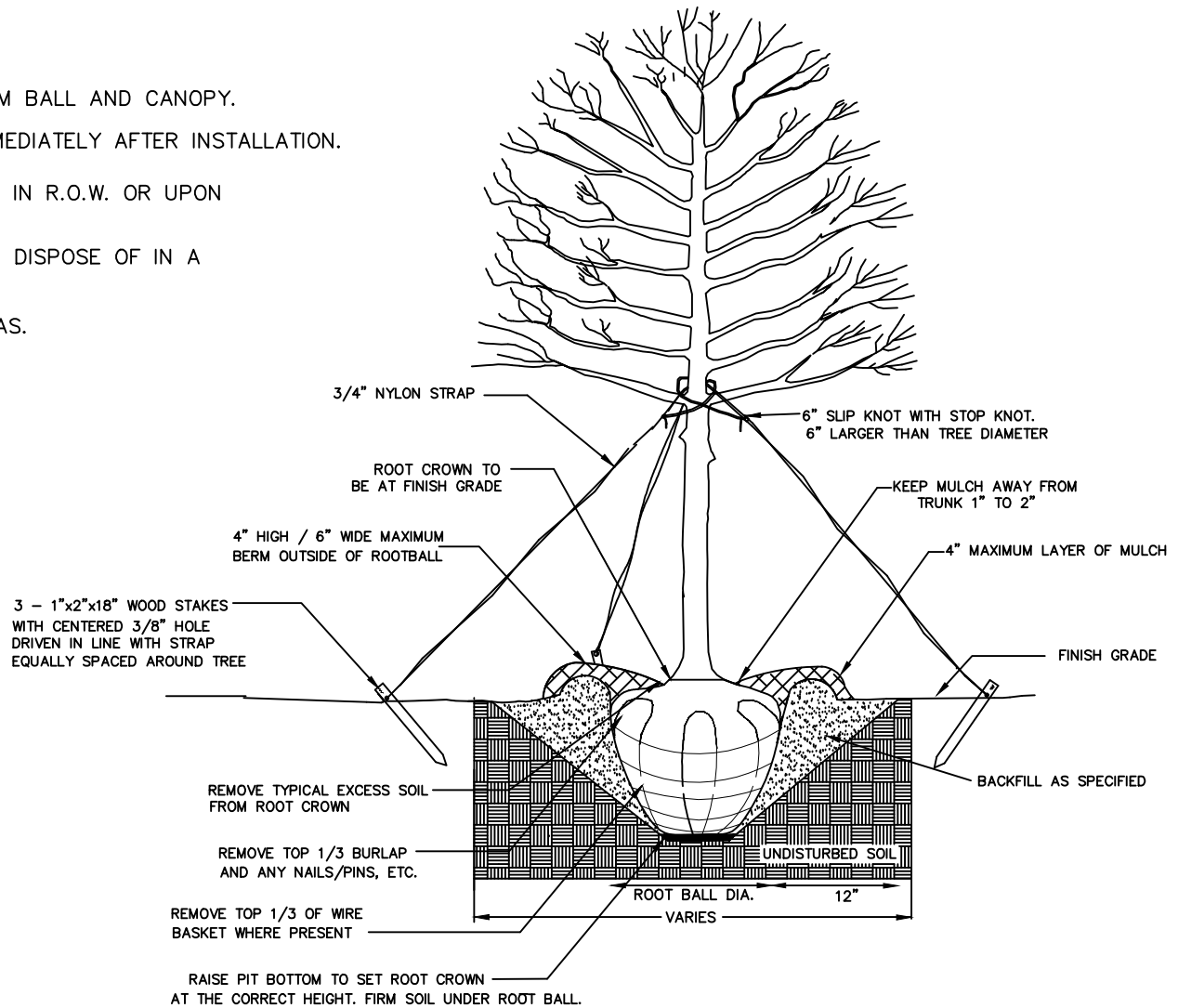

ALL TREES SHALL MEET AMERICAN STANDARD FOR NURSERY STOCK (ANSI Z60.1-2004)  
 FOR EXAMPLE:

CALIPER	HEIGHT (RANGE)	MAX. HEIGHT	MIN. ROOT BALL DIA.	MIN. ROOT BALL DEPTH
2"	12-14'	16'	24"	16"
3"	14-16'	18'	32"	21"

NOT TO SCALE

# TREE PLANTING

## (SINGLE AND MULTI-STEM TREES)



CITY OF LEXINGTON  
 INFRASTRUCTURE  
 DEVELOPMENT STANDARDS

REV.	STD. NO.
1	2001

SEE APPROVED TREE PRESERVATION PLAN FOR REQUIRED RADIUS OF TREE BARRIER

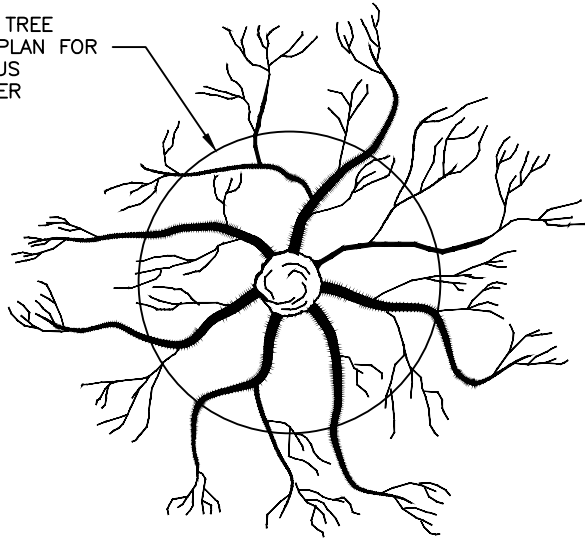

PLAN VIEW OF ROOT ZONE

**NOTES:**

1. REMOVE ALL BARRIERS UPON COMPLETION OF PROJECT.
2. LANDSCAPING PLANS SHALL SHOW THE LOCATIONS OF ALL TREE PROTECTION FENCES.

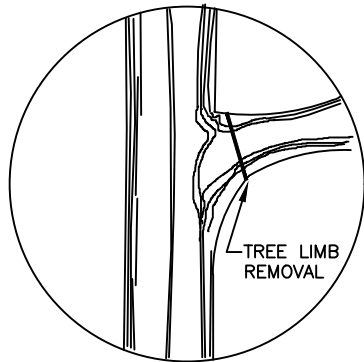

FOR PRUNING SEE INTERNATIONAL SOCIETY OF ARBORICULTURE SPECS.

DEAD TREES AND SCRUB OR UNDERGROWTH SHALL BE CUT FLUSH WITH ADJACENT GRADE. NO GRUBBING ALLOWED UNDER DRIP LINE.

2"x4" STANDARDS + 1"x4" RAILS OR ORANGE SAFETY FENCING MAY BE USED.

ONE FOOT FOR EACH INCH OF TRUNK DIAMETER OR 1/2 HEIGHT OF TREE WHICHEVER IS GREATER

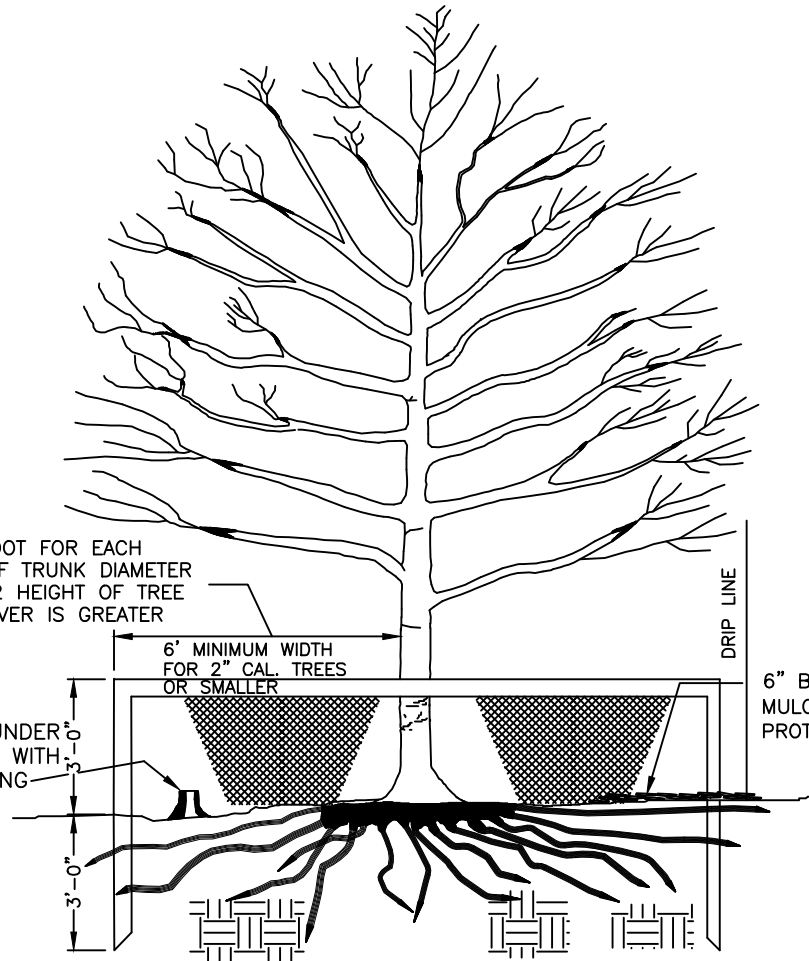

6" BARK MULCH, PLACE BARK MULCH AT AREAS NOT PROTECTED BY BARRIER.

NOT TO SCALE

# TREE PROTECTION

REV.	STD. NO.
1	2002



CITY OF LEXINGTON  
INFRASTRUCTURE  
DEVELOPMENT STANDARDS

NOTES:

1. THIS TREE BUMPER DETAIL SHALL BE USED WHEN WORKING WITHIN 10' OF AN EXISTING TREE TO BE PROTECTED.
2. ALL TREES SHALL BE SAVED UNLESS NOTED OTHERWISE ON THE PLANS OR DIRECTED BY THE ENGINEER.
3. LUMBER, WIRE, AND SANDBAGS MAY BE REUSED AT OTHER TREES.
4. THE INTENT OF THIS DETAIL IS TO PROTECT EXISTING DURING CONSTRUCTION TREES FROM DAMAGE ARM SWING. AN ESPECIALLY FROM BACKHOE BE USED IF ALTERNATE APPROACH MAY APPROVED IN WRITING BY THE ENGINEER AFTER CONSULTATION WITH CITY ENGINEER.

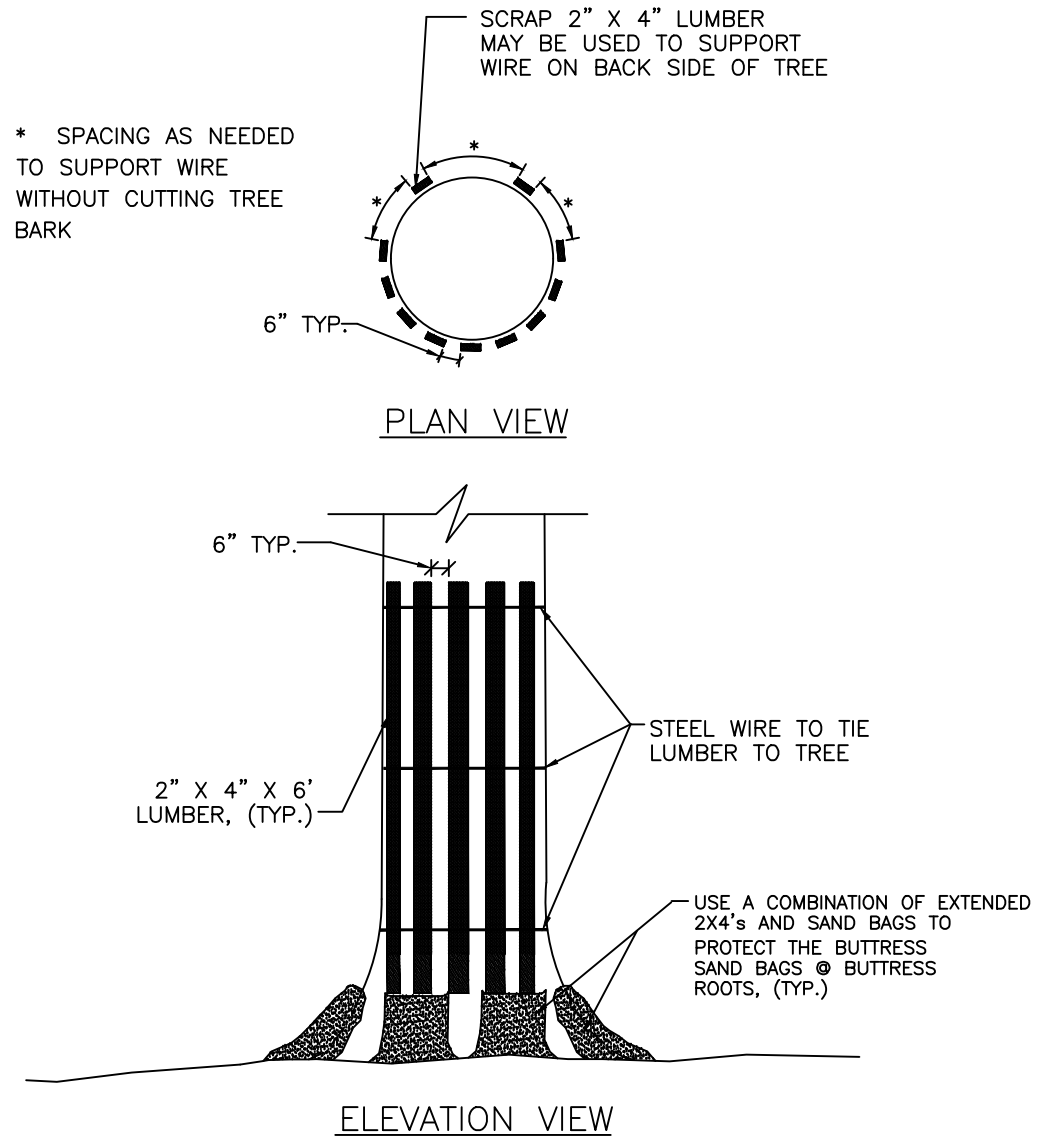

NOT TO SCALE

# TEMPORARY TREE PROTECTION

REV.	STD. NO.
1	2003



CITY OF LEXINGTON  
INFRASTRUCTURE  
DEVELOPMENT STANDARDS

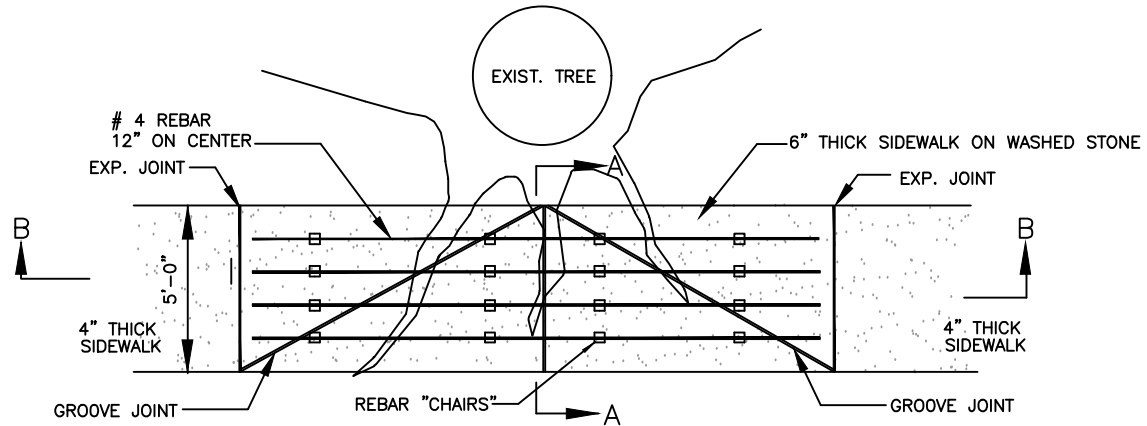

PLAN VIEW

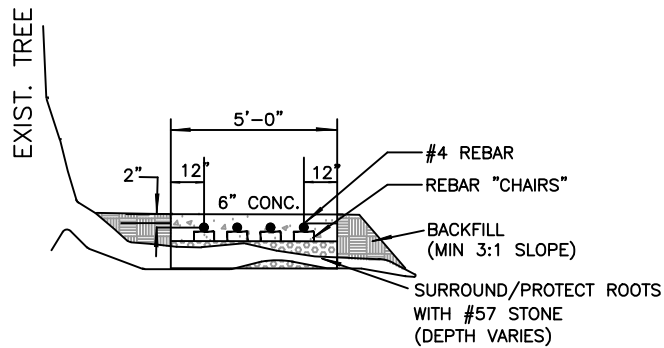

SECTION A-A

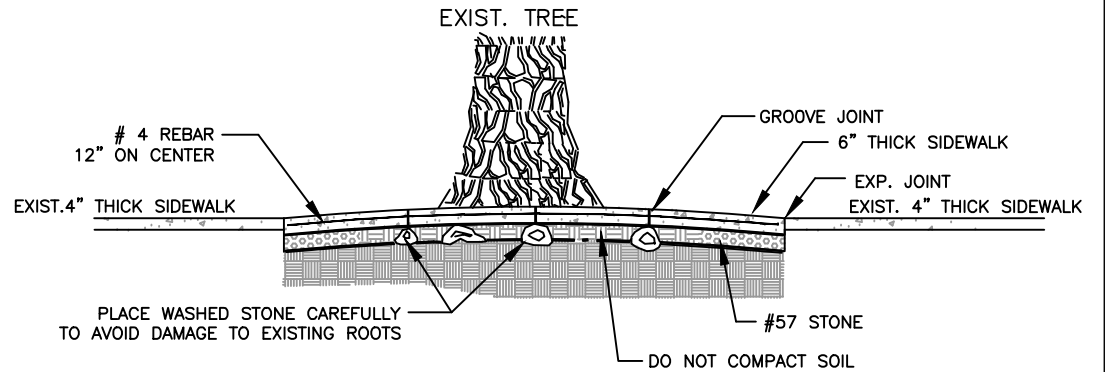

SECTION B-B

NOT TO SCALE

# BRIDGING TREE ROOTS WITH REINFORCED CONCRETE SIDEWALK

REV.	STD. NO.
1	2004



CITY OF LEXINGTON  
INFRASTRUCTURE  
DEVELOPMENT STANDARDS